



Fire 92

High-Performance Passive Line Array System



Overview

Part of our Fire series, the Fire 92 is a high-performance dual 12" Line Array loudspeaker system optimized to deliver high-fidelity and wide coverage in live, touring, DJ, and installation applications.

Key Features

• Enclosure Features

The Fire 92 incorporates 2 x 12" Mid-Bass transducers & 2 x 2" High Quality HF transducers with state of the art Waveguide horn, all comprised into a sleek enclosure. This Array module has a horizontal coverage angle of 120° & vertical Coverage angle of 9°.

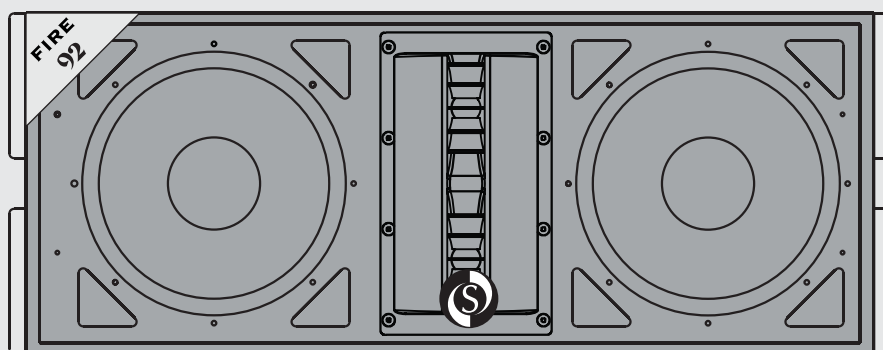

• About Waveguides



• Enclosure Hardware

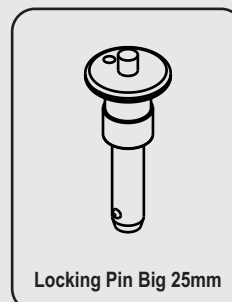
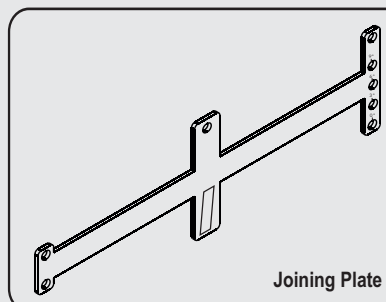

• Fire 92 Kit

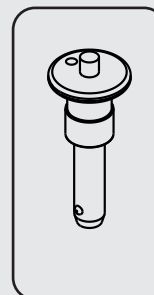
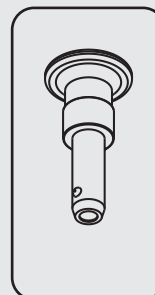
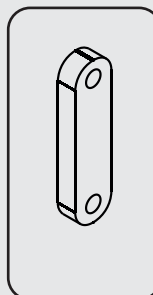
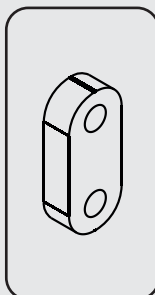
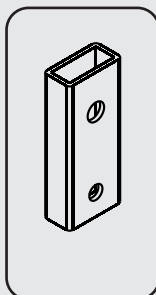
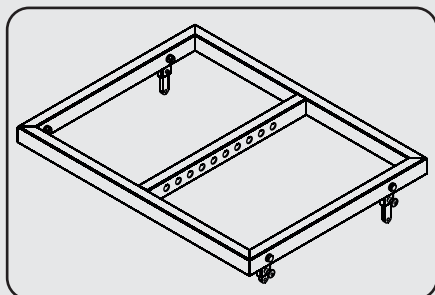

All Features



- High performance dual 12" LF and 1" HF transducers.
- High Frequency attenuation for selection of throw.
- Constant Curvature waveguide for unprecedented array coherence.
- Coverage Pattern: 120° x 9° nominal (horizontal x vertical), single unit.
- State-of-the-art crossover design for the highest audio efficiency, fidelity, and enhanced frequency response.
- Exceptional sound quality, powerful response, and a long throw.
- Professional-quality dual Speakon connectors for input connectivity and linking additional loudspeakers.
- High-endurance and durable cabinet design with a scratch-resistant paint finish built for the road.
- Ergonomically-shaped handles for easy transportation.
- Heavy-gauge perforated metal grille for optimal speaker protection.
- Fast, integral rigging system with variable splay angles.

System Consists of:

- Fire 92 Line array module
- Fly bar

Technical Specifications

Parameter	Specifications
Type	Line Array
Power Output - RMS / Peak (Watts)	1100 / 2200
Frequency Response	80Hz-18kHz
System Maximum SPL (dB)	133
Sensitivity (1w @ 1m)	98dB LF / 100dB HF
LF Driver Size	2 x 12" woofers with 4" inside/outside voice coil
HF Driver Size	2 x 2" exit with 1.75 voice coil
Nominal Impedance (Ω)	8
Horizontal Coverage Angle	120°
Vertical Coverage Angle	9°
Crossover Frequency	2200Hz
Input Connectors	2 x Speakon
Variable Splay Angles	0°, 3°, 6°, and 9°
Dimensions (W x D x H) mm	960 x 560 x 386
Net Weight Fire 92 (Kg)	60
Net Weight Fire 92 Fly Bar (Kg)	17

Dimensions



Support

For sales, support, pricing and availability:
Email: info@audioplus-india.com
Telephone: 022-42869000 / 001
WhatsApp: +91-8879028079
(Monday to Saturday between 10:00 a.m to 6:00 p.m.)
Contact Us:
<http://www.studiomasterprofessional.com/home/contact>



Scan QR Code for More Details

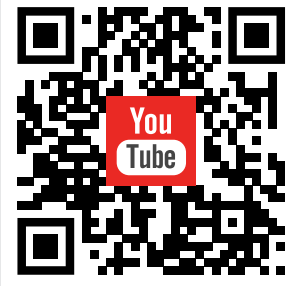

Scan QR Code to Watch Video

For after-sales service and support: Email: sales.support@audioplus-india.com Telephone: 022-42869010 / 49 / 57

Subscribe to our Channel

Studiomaster[®]
PROFESSIONAL

On  YouTube



bit.ly/SMPYT-S



Studiomaster Professional



* Product design and specifications are subject to change without notice.

Studiomaster Professional is a registered trademark of Audioplus in India. © Copyright Audioplus, 2008. All rights reserved. Any unauthorised reproduction or use of logos, images or design elements is strictly prohibited by law. No part of the compilation may be reproduced in any manner or translated without written permission.

Code: Rev000 / SMP Fire 92 Datasheet / July 2020

Brought to you by:

AUDIOPLUS

A1/A2, Giriraj Indl. Est., Mahakali Caves Road, Andheri (E), Mumbai - 400 093, India Tel.: +91-22-4286 9000/ 001 W: www.audioplus-india.com