

SM Professional[®]

ZT22

Dual UHF Headworn Rechargeable Wireless Microphone System



- ✓ No Heavy Bodypack Transmitter
- ✓ No External Batteries Required

- ✓ No Messy Wire Clutter
- ✓ No Hassle Setup & Connection



DUAL HEADWORN MICROPHONES



SINGLE RECEIVER



COMFORTABLE & LIGHTWEIGHT DESIGN



UNIDIRECTIONAL PICKUP PATTERN



EXCEPTIONAL VOCAL CLARITY



RECHARGEABLE BATTERY



MICRO USB CHARGING PORT



PLUG & PLAY CONNECTIVITY

-Features
-Operating Instructions
-Technical Specifications
-Safety Instructions

The Studiomaster Professional ZT 22 is a high quality dual UHF headworn rechargeable wireless microphone system ideal for presentations, speech, singing, live performances, classrooms, houses of worship and mobile PA applications. To ensure optimum performance & safety, please follow this instruction manual carefully. Please retain this manual for future reference. For any complaint, feedback or testimonials, please contact our distributor / dealer.

1. Features

- Dual headworn wireless microphone.
- Comfortable and lightweight design.
- Unidirectional pickup pattern.
- Exceptional vocal clarity.
- Compact single plug and play receiver unit.
- Built-in rechargeable batteries in the transmitter (microphones) and receiver units.
- Deploy up to 8 sets (16 microphones) at the same time.
- Quick charging via standard DC 5V micro-USB cable.
- External windscreen to reduce wind and pop noise.
- Ideal for presentations, speech, singing, live performances, classrooms, houses of worship and mobile PA applications.

2. Operating Instructions

2.1 Receiver Features:

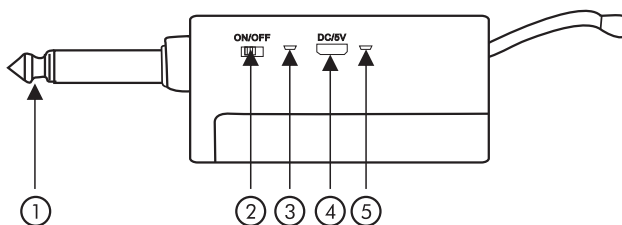

- 1. Audio Output:** This 1/4" (6.35mm) Unbalanced TRS Jack is provided to connect the audio output to the input of a Mixer/Amplifier/Powered speaker.
- 2. Power ON/OFF Switch:** It is used to switch the receiver ON/OFF.
- 3. Power and Charging LED Indicator:** This two colour LED shows the power ON and charging status of the receiver. The Green LED indicates that the receiver is ON and is powered by the internal battery. The Red LED indicates that the battery is being charged. The LED indicator turns OFF when the unit is fully charged.
- 4. Power Jack:** This standard micro USB connector is provided for 5V DC input voltage to power up and charge the receiver.
- 5. Pairing Status LED Indicator:** This LED indicator displays the pairing status between the receiver and the transmitters (headworn microphones).

2.2 Headworn Microphone Transmitter Features:

- 1. Power ON LED:** This Red LED glows to indicate the power ON status of the transmitter.
- 2. Power ON/OFF Switch:** Long press to switch the microphone ON or OFF.
- 3. Code Switch:** This switch is used to match and pair the transmitter with the receiver.
- 4. Power Jack:** This standard micro USB connector is provided for 5V DC input voltage to power up and charge the transmitter.
- 5. Charging LED Indicator:** This Green LED lights up to indicate that the internal battery is charging. The LED indicator turns OFF when the unit is fully charged.
- 6. VOL+ & VOL- Switches:** Long press these switches to increase or decrease the volume of the microphone as required.

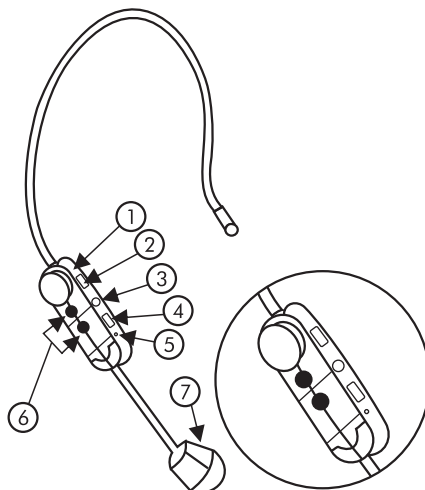

7. Mic Capsule: This high quality microphone capsule picks up the voice of the person speaking. For best results, kindly make sure that the perforated side of the microphone is facing your mouth at an approximate distance of 20mm. Adjust the position as required. Use the windscreen foam to reduce pops, wind, thumps and plosive sounds.

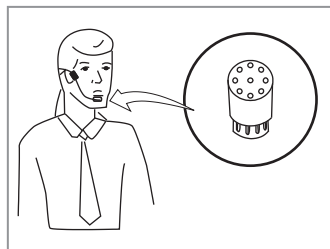

2.3 Battery & Charging Instructions:

Receiver:

1. Slide down to open the battery cover (Fig. A).
2. Insert the supplied rechargeable battery into the compartment. (Fig. B).
3. After inserting the battery, slide up to close the cover (Fig. C).
4. Connect the supplied power adapter and micro-USB cable to charge the unit.
5. Give the receiver a full charge before using the unit for the first time. The Red LED indicates that the battery is being charged. The LED indicator turns OFF when the unit is fully charged. See pt. 2.1.3 for more details.

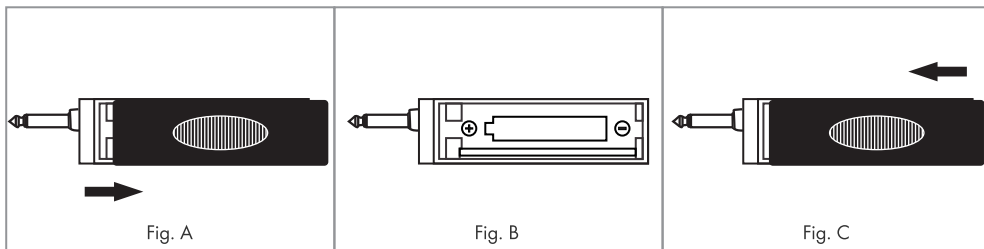

Headworn Microphone Transmitter:

1. Connect the supplied power adapter and micro-USB cable to charge the unit.
2. Give the transmitter a full charge before using the unit for the first time. The Green LED lights up to indicate that the internal battery is charging. The LED indicator turns OFF when the unit is fully charged. See pt. 2.2.5 for more details.

Note: The batteries in the headworn microphone transmitter are pre-inserted. Please do not try to open the unit. Doing so will void your warranty.

2.4 Pairing:

1. Power up the receiver and the transmitter microphone at the same time.
2. Long press the CODE switch on the transmitter microphone till the Red LED starts flashing. The transmitter is now in pairing /matching mode.
3. Now, single press the CODE switch. The Red LED on the receiver flashes thrice to indicate that two units are matched and paired. Single press the CODE to confirm successful pairing. The Red LEDs on both the receiver and microphone transmitter remain lit to indicate the same.
4. If you face any interruptions, dropouts or poor connections, kindly repeat the above steps till the issue is resolved.

2.5 Connection & Usage:

1. Insert the 1/4" (6.35mm) unbalanced TRS Jack of the receiver into the input of your mixer, amplifier, powered speaker or audio device.
2. Increase the volume on the microphone transmitter until you hear the audio signal. If the audio is distorting or unclear, reduce volume accordingly.

2.6 Usage Tips:

1. Make sure you can always see the receiver antenna from the transmitter position.
2. Keep the distance from transmitter to receiver as short as possible
3. Avoid any obstruction between the transmitter and the receiver.
4. Perform a "Walk Test" before a performance or presentation. If dead spots are found, adjust the location of the receiver or microphone transmitter. If dead spots remain, mark and avoid them.

3. Technical Specifications

System

Operating Frequency	Channel A: 600-649MHz Channel B: 650-699MHz
Frequency Response	50Hz-15KHz
Working Distance	30 meters

Receiver

Battery Type	Rechargeable 3.7V 1200mAh Lithium
Power Supply	USB 5V 500mA-1A

Microphone Transmitter

Transmitter Power	10dBm (10mW)
Capsule Type	Condenser
Battery Type	Rechargeable 3.7V 400mAh Lithium
Power Supply	USB 5V 500mA-1A

4. Safety Instructions

- Keep the wireless receiver in a good location to ensure good signal strength.
- Please keep the product away from direct sunshine & rain.
- Please keep the product away from heavy magnetic or electromagnetic fields, it could affect product performance.
- Please switch off when removing the batteries.
- Please remove the batteries/power supply when the product is not being used for a long time.
- Do not open any of the components yourself, for repairs please contact an authorised Studiomaster Professional service centre.
- Do not use systems with the same frequency at the same place, please separate them by a considerable distance.

 +91-22-42869000 +91-22-42869001	Subscribe to our Channel   bit.ly/SMPYT-S  studiomaster professional 🔍
 WhatsApp +91-8879028079	
 info@audioplus-india.com	

SMP^{Professional} is a registered trademark of Audioplus in India. © Copyright Audioplus, 2008. All rights reserved. Any unauthorised reproduction or use of logos, images or design elements is strictly prohibited by law. No part of the compilation may be reproduced in any manner or translated without written permission.